

# Product data sheet

## Metal keyring

Product number: 9227007

Our rectangular metal keychain with a wavy back is a stylish and versatile option for showcasing your brand or message. **Product Highlights:** **High-Quality Material:** This keychain is made of high-quality metal, ensuring both durability and an appealing appearance. **Wavy Back:** The wavy back gives this keychain a unique charm and style. It's a subtle design aspect that stands out. **Matte Brushed Interior:** The interior of the keychain is matte brushed, giving it a modern and elegant texture. **Rectangular Shape:** The rectangular shape of this keychain provides it with a classic look, allowing for a clear presentation of your engraving. **Practical Key Ring:** The integrated key ring makes it easy to attach this keychain to your keyring or other items. **Print option:** The matte brushed surface offers ample space for a laser engraving. This provides you with the opportunity to place your logo in a precise and subtle manner.

## Stock and income

Color	Current stock	Reserved	Incoming goods
Silvergrey	8313	0	10000 (CW 35)

## Product images

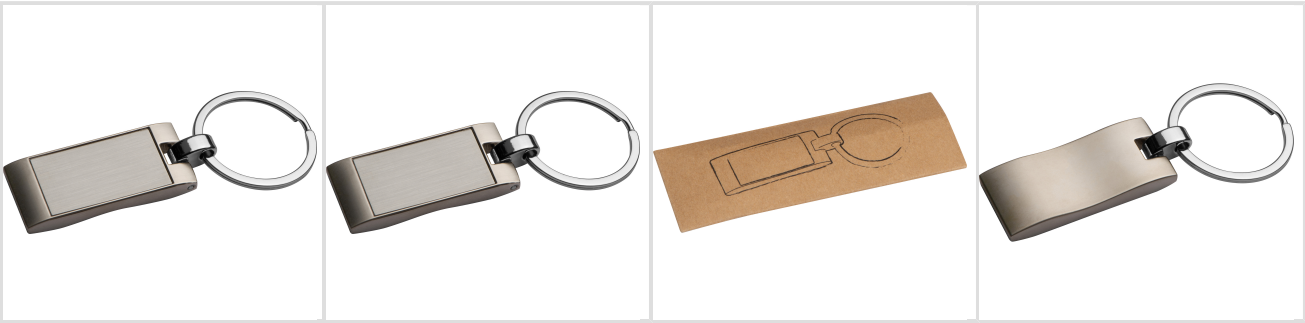

## Additional information

### General

Product length	86 mm
Product width	35 mm
Product height	6 mm
Material	Metal
Weight	0.042 kg
Country of origin	China
Customs tariff number	73269098900

### Print

Finishing types	Laser engraving
Printgroup 1	Laser engravement (L2)
Name 1 print area 1	Below the keychain
Possible colors printgroup 1	1
Print area 1 width	30 mm
Print area 1 height	15 mm

### Packaging

Type of packaging	Carton and paper sleeve
Quantity bulk packaging	200
Quantity small packaging	50

## Product data sheet

Metal keyring

Product number: 9227007